

Media Release – For immediate use

1st October, 2020

Sanford Gets New \$5.7m Salmon Barge for Stewart Island Farm

Seafood company Sanford is embarking on the new fishing and financial year commencing October with a brand new \$5.7m feed barge, specially made for its salmon farming operations in Big Glory Bay, Stewart Island.

Sanford is New Zealand's biggest and oldest seafood company and has been farming salmon in Stewart Island waters since April 1993.

GM Aquaculture Ted Culley says the barge is part of Sanford's strategic plan to enhance operations on the salmon farm.

"This new barge is an asset upgrade and replaces the Kiwa, our existing 1960s-built barge, which will be retired and towed back to Bluff to be scrapped. With the amount of growth at Stewart Island, the new barge also assists Sanford's vision to expand further out to sea in Southland."

The barge named San Hāmana (hāmana meaning salmon in te reo) has a particular arrangement and had to be ordered to design, from a specialist marine construction company in Hobart, Australia where it took nine months to build.

The barge has four silos that can hold in total 200 tonnes of fish food, and a computer system that automatically puts the feed through pipes into the fish pens. The latest technology equipment, including underwater cameras, keeps watch on the salmon and provides a variety of data such as feed allocations and water conditions.

Ted says "Stewart Island is a pristine environment and is home to clean water, untouched nature, and beautiful King Salmon which are recognised by the world-renowned Monterey Bay Aquarium as world's most environmentally sustainable farmed salmon. Controlling our feed output using the latest technology helps us preserve that perfect environment we are so lucky and grateful to be working in."

GM Engineering Peter Young says the barge also provides a great environment for humans with Sanford's Stewart Island based crew looking forward to the new surroundings.

"The new kitchen and sleeping facilities are top notch and our team are really looking forward to the barge arriving on the farm. It will be fully operational by the end of October"

The 26-metre long steel barge was launched from Hobart in mid-August and towed by an Australian tugboat across the Tasman. With Covid-19 restrictions at the maritime border, Ministry of Health Director-General Dr Ashley Bloomfield personally granted permission for the San Hāmana to enter New Zealand. The barge arrived in Bluff harbour on Sunday 13 September.

San Hāmana specs:

- Overall length: 27.8m
- Beam: 11.83m
- Draft: 2.1m
- Estimated gross tonnage: 658 tonnes
- Feed capacity: 200mt, contained in 4 x 50mt silos
- Accommodation: 5 personnel, overnight

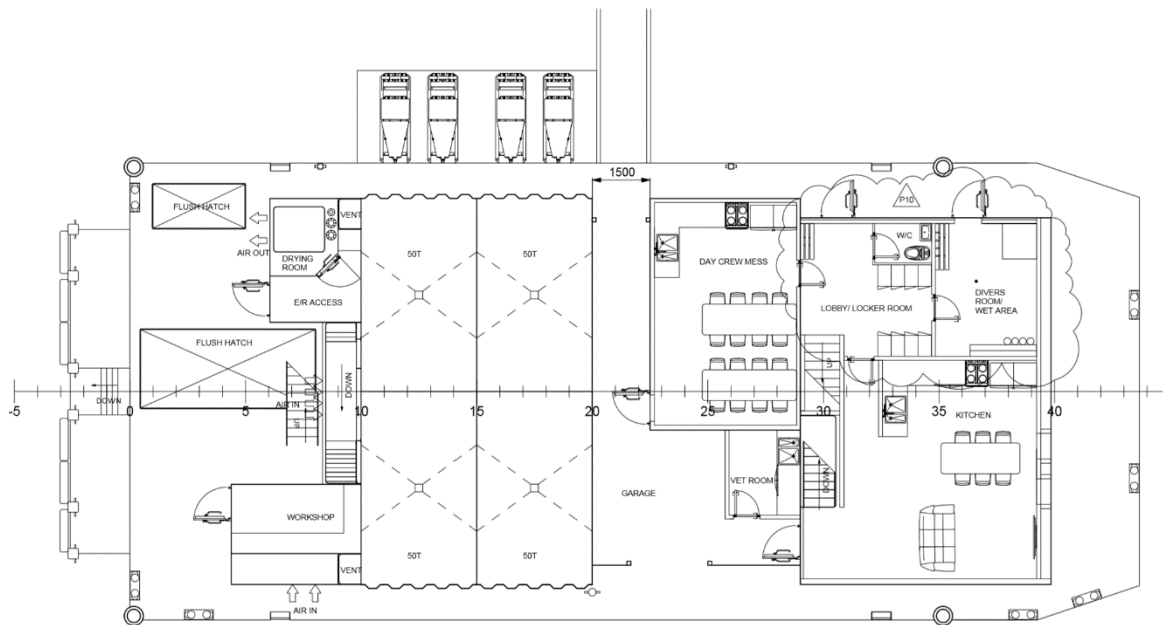

MAIN DECK
3400

Pictured above: A diagram of the San Hāmana main deck general arrangement

ENDS

Images of Sanford's barge, the San Hāmana, are available here:

<https://www.dropbox.com/sh/g5ttgstg6nvu205/AABofMF0ulqztV1pk7Nyfxv9a?dl=0>

For more information or to arrange interviews, please contact:

Fiona MacMillan

GM Corporate Communications

+64 (0)21 513 522

fmacmillan@sanford.co.nz

About Sanford Ltd

Sanford is New Zealand's oldest and largest seafood company - we farm salmon and mussels and hold 19% of New Zealand commercial fishing quota. Sanford has been listed on the New Zealand stock market since 1924. We are focused on sustainability and on maximising the value of the resources we gather from our oceans, enabling long term value creation from oceans teeming with life. Sanford sites can be found in eleven locations around New Zealand and we are a team of 1,500 staff and sharefishers across the country. We are committed to innovation: our scientists are on a mission to find new ways to make the most of the life-enhancing properties of seafood, from anti-inflammatory supplements to skin-nurturing collagen.

For more information, please visit: www.sanford.co.nz